

## PANEL SIZING:

OVERALL LENGTH: 106.3 INCHES  
OVERALL WIDTH: 20.5 INCHES  
OVERALL THICKNESS: 0.86 INCHES

## BASE MATERIAL:

MADE FROM RECYCLED PET ACOUSTICAL  
FELT BACK - 3/8" THICKNESS



## FLAME SPREAD:

CAN/ULC S102.2-18 STANDARD METHOD OF  
TEST FOR SURFACE BURNING

RATING OF 60 (CLASS B) SMOKE RATING 220

## SOUND REDUCTION:

CAN/ULC ASTM C423

MOUNT A - 50% NOISE REDUCTION NRC: 0.50

MOUNT C 50 - 100% NOISE REDUCTION: 1.00

MOUNT D 20 - 65% NOISE REDUCTION: 0.65



FSC CERTIFIED PRODUCT

PANEL COVERAGE: 15.13 SQ FT / PER

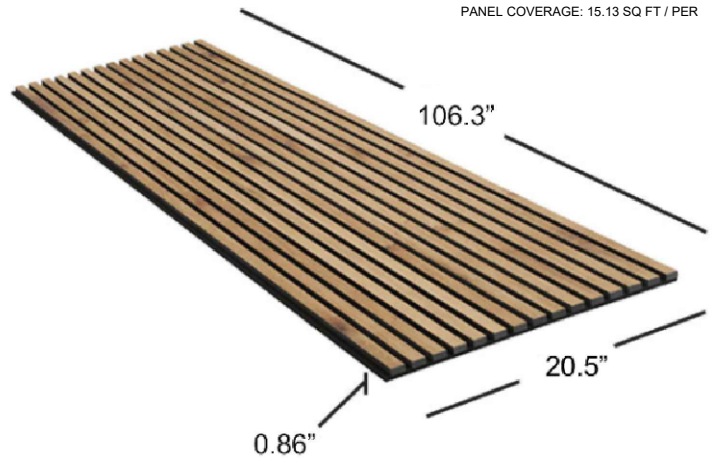

## SLATS:

CONSTRUCTED OF MDF SLATS FINISHED  
WITH WOOD VENEER

SLATS MEASURE 1 1/16" X 1/2" mm, WITH  
DISTANCE OF 1/2" BETWEEN.  
TOP TO BOTTOM THICKNESS IS 7/8"

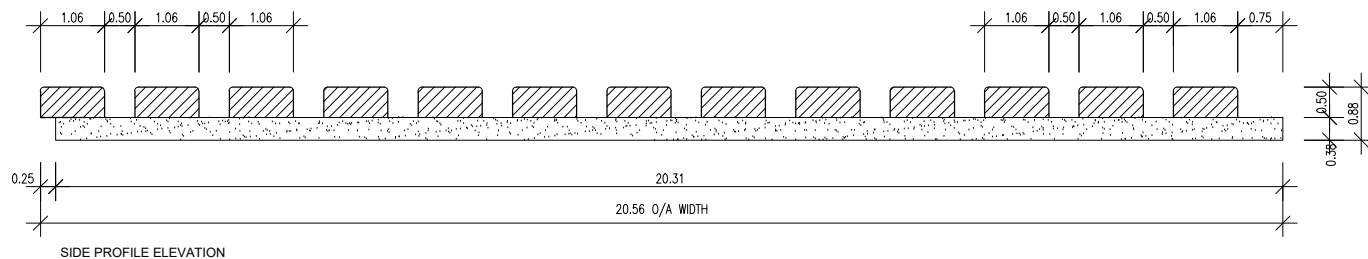
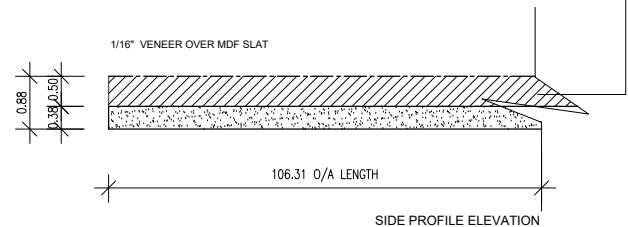

SIDE PROFILE ELEVATION

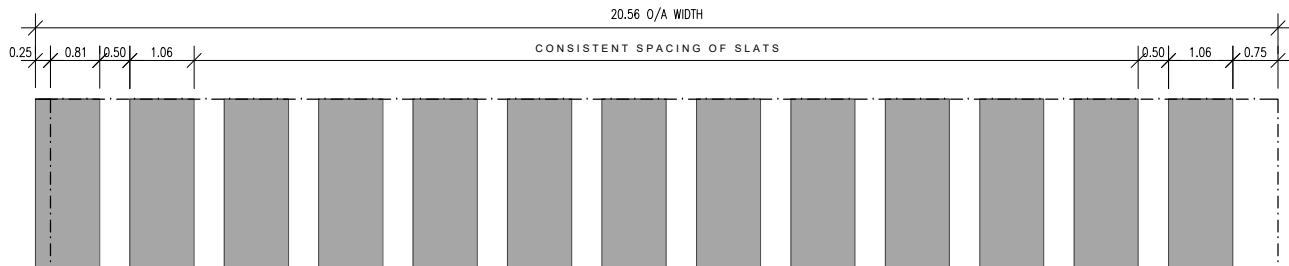

TOP PROFILE PLAN

REFER TO PANELUX WEBSITE FOR INSTALLATION GUIDELINES

GET IN TOUCH

ALL DIMENSIONS SHOWN ARE IN INCHES  
\*REFER TO WEBSITE FOR ALL AVAILABLE FINISHES  
REFER TO PANELUX WEBSITE FOR INSTALLATION GUIDELINES  
DO NOT SCALE

## PANELUX FELTED FINISH EDGE

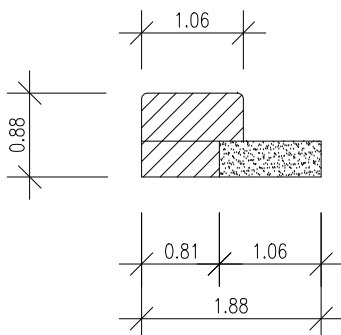

SIDE PROFILE ELEVATION

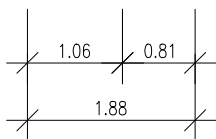
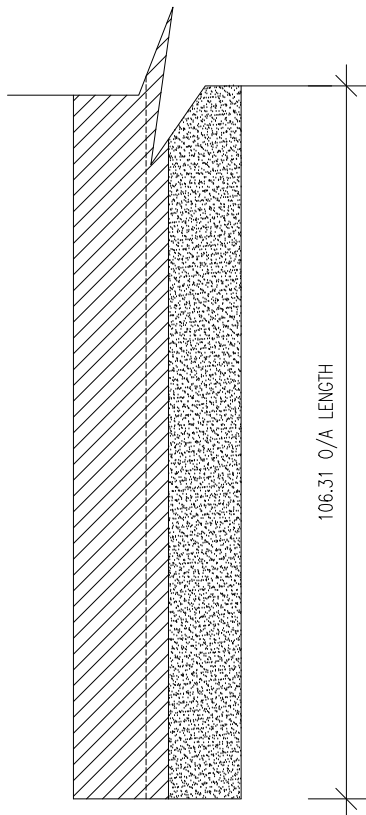

TOP PROFILE PLAN

## PANELUX FINISH EDGE

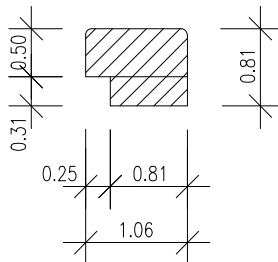

SIDE PROFILE ELEVATION

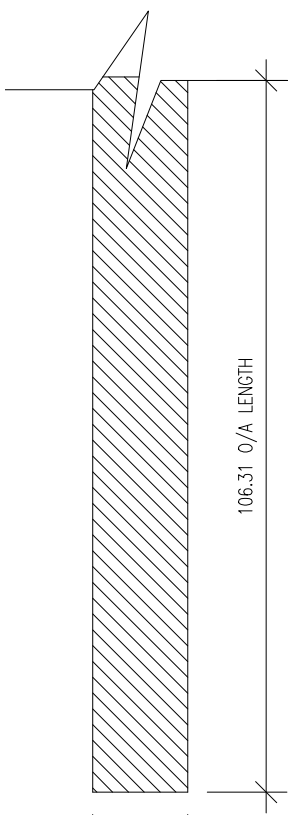

TOP PROFILE PLAN

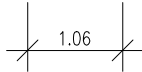

## **BASE MATERIAL:**

MADE FROM RECYCLED PET  
ACOUSTICAL FELT BACK - 3/8"  
THICKNESS

## **SLATS:**

CONSTRUCTED OF MDF SLATS FINISHED  
WITH WOOD VENEER

SLATS MEASURE 1 1/16" X 1/2", WITH A  
DISTANCE OF 1/2" BETWEEN.  
TOP TO BOTTOM THICKNESS IS 7/8"

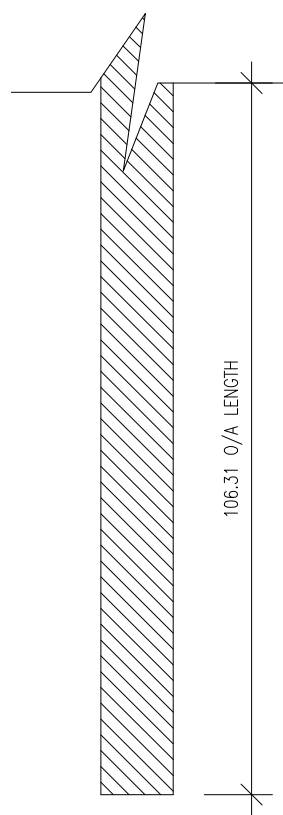

SIDE PROFILE ELEVATION

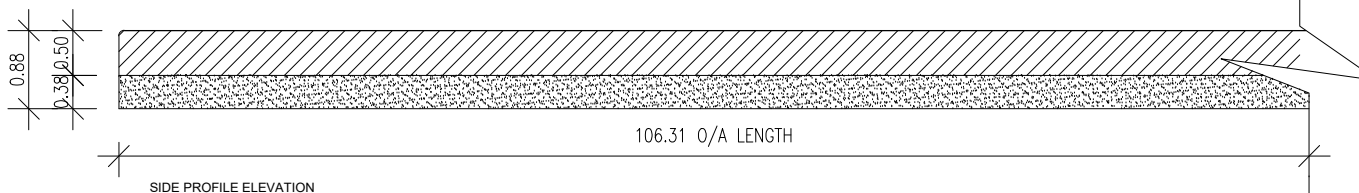

SIDE PROFILE ELEVATION